

14882

NOTES

1. THE CONTRACTOR SHALL LIAISE WITH ALL RELEVANT AUTHORITIES TO LOCATE ANY EXISTING SERVICES WITHIN THE CONTRACT AREA PRIOR TO THE COMMENCEMENT OF WORK. ANY COMPACTION WITHIN THE VICINITY OF THESE SERVICES TO BE CARRIED OUT TO SERVICE AUTHORITIES REQUIREMENTS.
2. THE CONTRACTOR SHALL OBTAIN ALL LEVELS FROM ESTABLISHED BENCHMARKS AS PROVIDED BY THE PROJECT SURVEYOR. ALL BENCHMARKS ARE TO BE PROTECTED.
3. THE CONTRACTOR SHALL BE BOUND TO THE "GUIDELINES FOR ASSESSMENT AND CONTROL OF DUST AND WINDBORNE MATERIAL FOR LAND DEVELOPED SITES" (INCLUDING APPENDICES 1 & 2) PUBLISHED BY THE D.E.P. - NOVEMBER 1996.
4. AREAS OF FILL TO BE COMPACTED IN LAYERS IN ACCORDANCE WITH THE SPECIFICATION. CONTRACTOR TO SUBMIT COMPACTION TEST RESULTS FOR ALL LOTS IN FILL.
5. ALL EARTHWORKS TO BE RESTRICTED TO THE LIMIT OF CONTRACT BOUNDARY. NO MACHINERY MOVEMENTS TO OCCUR OUTSIDE LIMIT OF CONTRACT BOUNDARY.
6. REFERENCE SHALL BE MADE TO THE RELEVANT CLAUSES OF THE EARTHWORKS SPECIFICATION WHERE WORK IS WITHIN PROPOSED ROAD RESERVES.
7. THE ENTIRE EARTHWORKED AREA (EXCEPT ROAD PAVEMENTS) SHALL BE STABILISED WITH HYDROMULCH IN ACCORDANCE WITH THE SPECIFICATION. THE CONTRACTOR SHALL PROVIDE DUST/WIND FENCING AND ADEQUATE DUST CONTROL DURING CONSTRUCTION. REFER TO SPECIFICATION.
8. THE CONTRACTOR SHALL TAKE CARE WITH THE USE OF COMPACTION EQUIPMENT WITHIN THE VICINITY OF THE EXISTING RESIDENCES SO AS TO AVOID VIBRATION DAMAGE TO BUILDINGS. COST OF REPAIRS FOR ANY DAMAGE INCURRED WILL BE THE RESPONSIBILITY OF THE CONTRACTOR.
9. SOME EXISTING TREES WITHIN FINISHED SURFACE AREA WILL BE FLAGGED AND ARE NOT TO BE DISTURBED. CLEARING IS NOT TO COMMENCE UNTIL THE TREES ARE IDENTIFIED BY THE SUPERINTENDENT. TREES FLAGGED ARE TO BE PROTECTED FROM MACHINERY AND CONSTRUCTION ACTIVITIES. (MIN. SEPARATION 3m FROM HAUL ROUTE TO BASE OF TREE)
10. CONTRACTOR TO STRIP TOPSOIL AND REMOVE OFF SITE.
11. FINISHED SURFACE CONTOURS SHOWN ARE TOP OF PAVEMENT. CONTRACTOR TO CONSTRUCT EARTHWORKS TO BOX OUT STAGE.
12. CONTRACTOR TO REMOVE FROM SITE ALL RUBBISH (ie. CAR BODIES, DRUMS, ETC) WITHIN THE EARTHWORKS BOUNDARY TO AN APPROVED LOCAL AUTHORITY DISPOSAL SITE. ALL FEES TO BE PAID BY THE CONTRACTOR.
13. AT EDGE OF EARTHWORKS BOUNDARY, CONTRACTOR TO BATTER AT 1 IN 6 TO NATURAL SURFACE, UNLESS OTHERWISE NOTED.
14. THE CONTRACTOR SHALL NOTE THAT NON-TRAFFICABLE SUBTERRANEAN STRUCTURES AND/OR VOIDS (SOAKWELLS, ETC.) MAY EXIST ON THE SITE AND SHALL TAKE ADEQUATE MEASURES TO LOCATE THESE PRIOR TO COMMENCING WORKS AND SHALL ADOPT SAFE WORK PRACTICES THAT OBVIATE ANY RISK THAT SUCH STRUCTURES MAY PRESENT.
15. THE SUPERINTENDENT HAS NOT INVESTIGATED THE SITE & MAKES NO REPRESENTATION AS TO WHAT MAY EXIST ON OR BELOW THE SITE. THE CONTRACTOR SHALL MAKE THEIR OWN INVESTIGATIONS AS TO THE NATURE OF THE SUBSURFACE CONDITIONS OF THE SITE.
16. PRIOR TO EARTHWORKS THE CONTRACTOR SHALL LOCATE ANY SOAKWELLS, SEPTIC TANKS, STRUCTURES AND DELETERIOUS MATERIAL AND REMOVE AND BACKFILL. ANY UNUSED PIPEWORK LOCATED SHALL BE REMOVED. SEPTIC TANKS SHALL BE DECOMMISSIONED AS PER THE LOCAL AUTHORITY REQUIREMENTS.
17. THE CONTRACTOR SHALL RAKE THE SITE AND STOCKPILES AND REMOVE UNSUITABLE MATERIAL OFF SITE. THE STOCKPILES MAY REQUIRE SCREENING TO SEPERATE THE UNSUITABLE MATERIAL.
18. DELETERIOUS AND UNSUITABLE MATERIAL SHALL BE REMOVED OFF SITE.
19. IMPORTED FILL SHALL BE CLEAN AND FREE DRAINING SAND.
20. THE CONTRACTOR SHALL PROVIDE TEMPORARY FENCING TO EXISTING LOTS WHERE REQUIRED.
21. THE CONTRACTOR SHALL PROVIDE TEST RESULTS AND COMPACTION CERTIFICATES UPON COMPLETION OF EARTHWORKS.

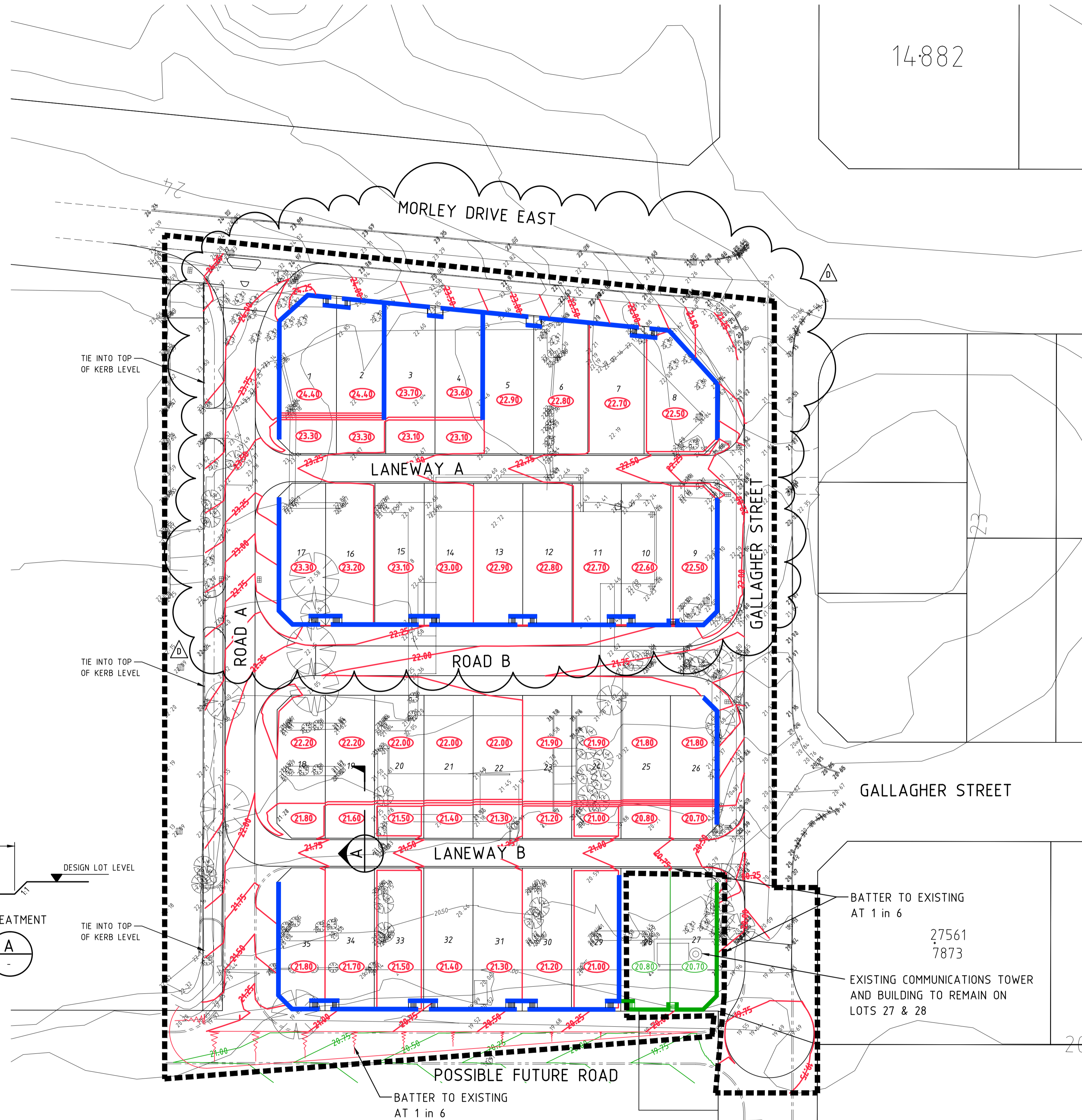

LEGEND

- 67 — NATURAL SURFACE CONTOUR
- 75 — FINISHED SURFACE CONTOUR
- 70.76 — FINISHED LOT PAD LEVEL
- 71.16 — FINISHED SURFACE LEVEL
- LIMIT OF CONTRACT BOUNDARY
- KERB LINE
- PROPOSED RETAINING WALL
- EXISTING RETAINING WALL
- 75 — FUTURE FINISHED SURFACE CONTOUR
- 70.76 — FUTURE FINISHED LOT PAD LEVEL

ALL BASE CONTOURS, LEVELS AND FEATURES HAVE BEEN PROVIDED BY A.J. MARSH PTY LTD SURVEYORS ON 13/02/2013



NOTE: ALL CO-ORDINATES SHOWN ON THIS DRAWING SHALL BE VERIFIED BY CONTRACTOR PRIOR TO COMMENCEMENT OF WORKS. ANY DISCREPANCIES TO BE REPORTED TO THE ENGINEER IMMEDIATELY.

No.	Revision	Checked	Approved	Date	No.	Revision	Checked	Approved	Date
D	RETAINING WALLS AND LEVELS AMENDED	ALS	PG	28.02.14					
C	FINISHED SURFACE CONTOURS AMENDED	ALS	PG	06.12.13					
B	ISSUED FOR APPROVAL	ALS	PG	30/08/13					
A	PRELIMINARY ISSUE	ALS	PG	20/05/13					

NOTE: COPYRIGHT OF THIS DRAWING IS RESERVED BY GROUNDWORK. THIS DRAWING SHALL BE READ IN CONJUNCTION WITH ALL OTHER RELEVANT DRAWINGS RELATING TO OTHER TRADES FOR ACCURATE CO-ORDINATION OF SERVICES. THE CONTRACTOR SHALL BE RESPONSIBLE FOR CHECKING ALL DIMENSIONS PRIOR TO COMMENCEMENT OF WORK. THIS DRAWING IS THE PROPERTY OF GROUNDWORK AND SHALL BE RETURNED UPON REQUEST. THIS DRAWING MAY ONLY BE USED FOR THE PURPOSE FOR WHICH IT WAS COMMISSIONED & IN ACCORDANCE WITH THE TERMS OF ENGAGEMENT FOR THE COMMISSION. UNAUTHORISED USE OF THIS DOCUMENT IS PROHIBITED.

Drawing File No.
6145-100.DWG

GROUNDWORK
Consulting Engineers

Telephone: (08) 9448-6656
Fax: (08) 9243-0861
PO Box 2165 MARMION 6020

Mobile: 0400-120-991
E-mail: www.gwk.net.au

Scale	0 10 20 30
1:500	
Drawn	RJH 12/05/13
Designed	RJH 12/05/13
Drafting Check	ALS 20/05/13
Design Check	ALS 20/05/13
Approved	
WAPE No.	14.6605

Client	MILUC PTY LTD
Job	LOT 3 MORLEY DRIVE EAST, EDEN HILL
Title	EARTHWORKS & RETAINING WALL LAYOUT
Original Size	A1
Drg. No.	6145-100
Revision	D